



Wibbow

# Brick DC-DC Converter (2nd Gen) Brochure



High power



High power density



Low EMI



Parallel

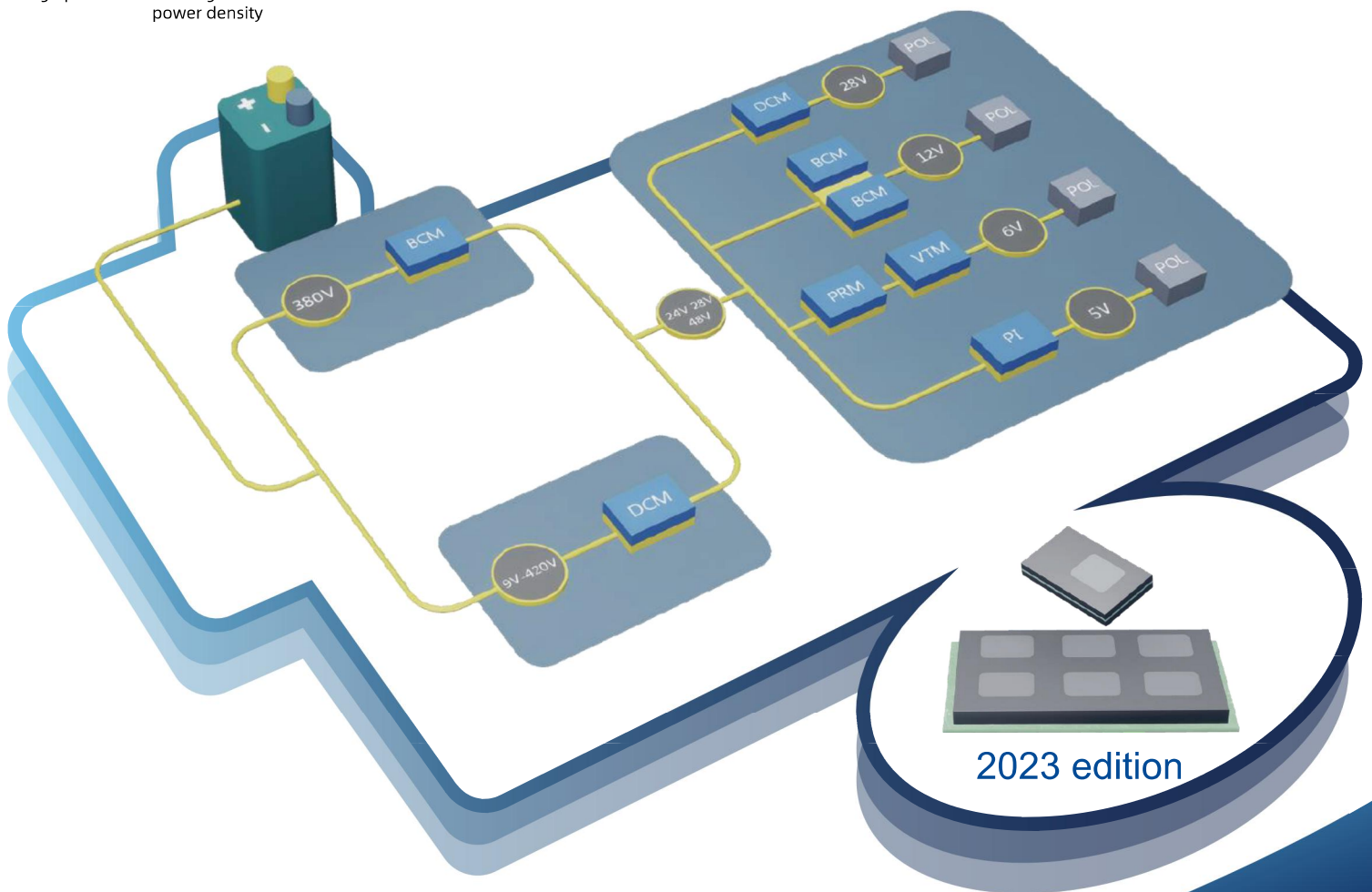



## Introduction to Brick DC-DC Converters (2nd Gen)

With high efficiency, high reliability and parallelling, the Brick DC-DC Converter is based on the patented PFM control circuit topology and embedding with silicone rubber sealed by metal base and plastic cavity, providing high-efficiency and high reliability DC/DC conversion output. It is completely compatible with the same series from Vicor and supports mixed insertion without changing any periphery parameters for replacement, ensuring easy use and providing about 5% higher conversion efficiency than the same series of Vicor; and the series also have comprehensive protections (against input over-voltage and under-voltage, output over-voltage, over-current, short circuit and over-temperature), enable control and fault monitoring functions. The product design and manufacture comply with the General Specification for Microcircuit Modules (SJ20668-1998), and are ideally for onboard, missile-borne, vehicle-mounted, ship-based electronic systems, TR components and other highly reliable electronic systems.

Product series	Input voltage range	Output voltage range	Output power	Parallel expansion	Electrical characteristics	Package size	Page
WBC24	18~40V	3.3V~48V	75~150W	Supported	Isolated, Regulated	57.9 x 36.8 x 12.7mm	3
WBB24	18~40V	3.3V~48V	150~350W	Supported	Isolated, Regulated	57.9 x 55.9 x 12.7mm	4
WBA24	18~40V	3.3V~48V	300~500W	Supported	Isolated, Regulated	116.8 x 55.9 x 12.7mm	5
WBC300	180~375V	3.3V~48V	75~150W	Supported	Isolated, Regulated	57.9 x 36.8 x 12.7mm	6
WBB300	180~375V	3.3V~48V	150~250W	Supported	Isolated, Regulated	57.9 x 55.9 x 12.7mm	7
WBA300	180~375V	3.3V~48V	264~600W	Supported	Isolated, Regulated	116.8 x 55.9 x 12.7mm	8
WBC375	250~425V	3.3V~48V	75~150W	Supported	Isolated, Regulated	57.9 x 36.8 x 12.7mm	9
WBB375	250~425V	3.3V~48V	150~300W	Supported	Isolated, Regulated	57.9 x 55.9 x 12.7mm	10
WBA375	250~425V	3.3V~48V	264~600W	Supported	Isolated, Regulated	116.8 x 55.9 x 12.7mm	11
WBM-FIAM	180~375V	180V~375V	600W	Not supported	Input filter	57.9 x 55.9 x 12.7mm	12
WB $\mu$ RAM	180~375V	30-30V	60W~900W	Supported	Ripple attenuation	57.9 x 36.8 x 12.7mm	13
WBVI-ARM	180~264Vac	200VDC~375VDC	750W	Not supported	Rectifier filter	57.9 x 36.8 x 12.7mm	14



## WBC24 Series Quarter Brick DC-DC Converter

### Features

- Isolated, Regulated
- Pin-to-Pin compatible with Vicor V24C series
- Input surge resistance: 50V/100ms
- Output adjustment range: 75% ~ 110%
- Over-voltage, under-voltage, over-current, short-circuit and thermal protections
- Supports 8 parallel expansion (ORING not required)
- 3000Vac isolation
- Operating temperature: -55°C~100°C (non-derating)
- Quarter brick standard package: 57.9 × 36.8 × 12.7 mm
- Comply with the General Specification for Microcircuit Modules (SJ20668)

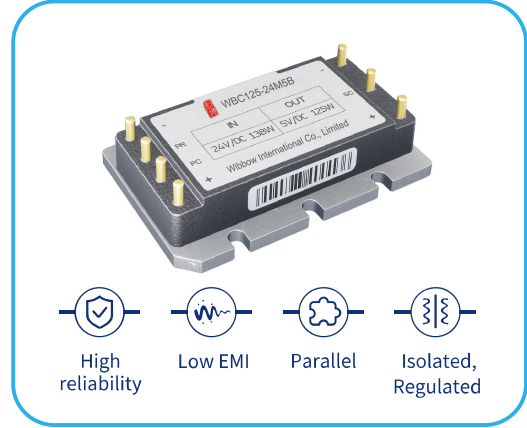

### Product specification

Product series	Input voltage range	Output voltage range	Adjustable range	Output current	Output power	Efficiency	Development progress
WBC75-24M3V3B	18~40V	3.3V	75%~110%	22.72A	75W	88.5%	Available
WBC125-24M5B	18~40V	5V	75%~110%	25A	125W	90.5%	Available
WBC125-24M8B	18~40V	8V	75%~110%	15.7A	125W	91%	Available
WBC150-24M12B	18~40V	12V	75%~110%	12.5A	150W	91%	Available
WBC150-24M15B	18~40V	15V	75%~110%	10A	150W	92%	Available
WBC150-24M24B	18~40V	24V	75%~110%	6.3A	150W	88.5%	Available
WBC150-24M28B	18~40V	28V	75%~110%	5.4A	150W	89.5%	Available
WBC150-24M36B	18~40V	36V	75%~110%	4.17A	150W	88%	Available
WBC150-24M48B	18~40V	48V	75%~110%	3.1A	150W	89.5%	Available

### Shape & Size

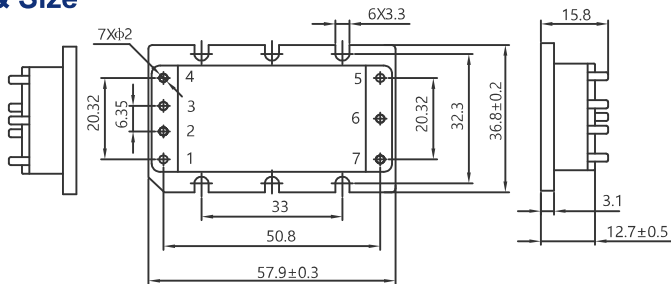

Pin No.	Label	Function
1	+IN	Positive input power terminal
2	PC	Primary side control
3	PR	Parallel terminal
4	-IN	Negative input power terminal
5	-OUT	Negative output power terminal
6	SC	Secondary side control terminal
7	+OUT	Positive output power terminal

### Part Numbering

WB	C	75	-	24	M	12	B
Brand Name	Package Type	Output power	-	Input voltage range	Temperature Grade	Output voltage range	Version
Wibbow	A: Full-brick B: 1/2 brick C: 1/4 brick	75: 75W 125: 125W 150: 150W		24: 18~40V	M : Tc: -55~100°C Ts: -65~100°C H : Tc: -40~100°C Ts: -55~100°C T : Tc: -40~100°C Ts: -40~100°C	3V3: 3.3V 5: 5V 8: 8V 12: 12V 15: 15V 24: 24V 28: 28V 36: 36V 48: 48V	B: Standard version



## WBB24 Series Half-brick DC-DC Converter

### Features

- Isolated, Regulated
- Pin-to-Pin compatible with Vicor V24B series
- Input surge resistance: 50V/100ms
- Output adjustment range: 75% ~ 110%
- Over-voltage, under-voltage, over-current, short-circuit and thermal protections
- Supports 8 parallel expansion (ORING not required)
- 3000Vac isolation
- Operating temperature: -55°C~100°C (non-derating)
- Half-brick standard package: 57.9 x 55.9 x 12.7 mm
- Comply with the General Specification for Microcircuit Modules (SJ20668)

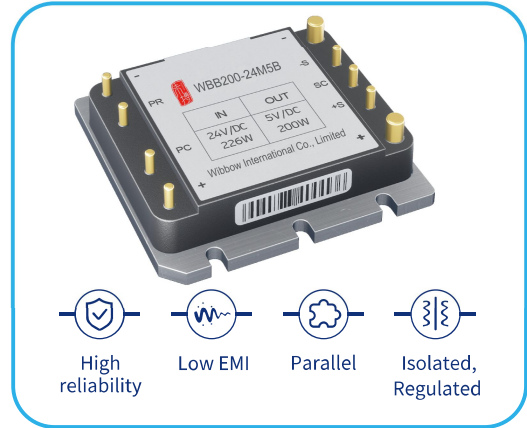

### Product specification

Product series	Input voltage range	Output voltage range	Adjustable range	Output current	Output power	Efficiency	Development progress
WBB150-24M3V3B	18~40V	3.3V	75%~110%	45.5A	150W	88.2%	Available
WBB150-24M5B	18~40V	5V	75%~110%	40A	150W	88.5%	Available
WBB200-24M8B	18~40V	8V	75%~110%	25A	200W	88.6%	In development
WBB200-24M12B	18~40V	12V	75%~110%	20.8A	200W	91.5%	In development
WBB200-24M15B	18~40V	15V	75%~110%	16.7A	200W	91.0%	In development
WBB200-24M24B	18~40V	24V	75%~110%	10.4A	200W	91.1%	Available
WBB200-24M28B	18~40V	28V	75%~110%	8.9A	200W	90.5%	Available
WBB200-24M36B	18~40V	36V	75%~110%	6.9A	200W	90.0%	Available
WBB200-24M48B	18~40V	48V	75%~110%	5.2A	200W	89.1%	Available

### Shape & Size

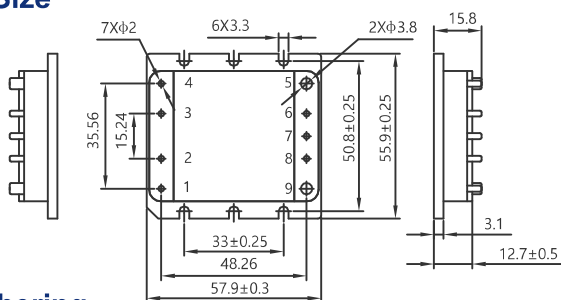

Pin No.	Label	Function
1	+IN	Positive input power terminal
2	PC	Primary side control
3	PR	Parallel terminal
4	-IN	Negative input power terminal
5	-OUT	Negative output power terminal
6	-S	Distal compensation negative terminal
7	SC	Secondary side control terminal
8	+S	Distal compensation positive terminal
9	+OUT	Positive output power terminal

### Part Numbering

WB	B	150	-	24	M	3V3	B
Brand Name	Package Type	Output power	-	Input voltage range	Temperature Grade	Output voltage range	Version
Wibbow	A: Full-brick B: 1/2 brick C: 1/4 brick	150: 150W 200: 200W		24: 18~40V	M: Tc: -55~100°C Ts: -65~100°C H: Tc: -40~100°C Ts: -55~100°C T: Tc: -40~100°C Ts: -40~100°C	3V3: 3.3V 5: 5V 8: 8V 12: 12V 15: 15V 24: 24V 28: 28V 36: 36V 48: 48V	B: Standard version



## WBA24 Series Half-brick DC-DC Converter

### Features

- Isolated, Regulated
- Pin-to-Pin compatible with Vicor V24A series
- Input surge resistance: 50V/100ms
- Output adjustment range: 75% ~ 110%
- Over-voltage, under-voltage, over-current, short-circuit and thermal protections
- Supports 8 parallel expansion (ORING not required)
- 3000Vac isolation
- Operating temperature: -55°C~100°C (non-derating)
- Full-brick standard package: 116.8 x55.9x12.7 mm
- Comply with the General Specification for Microcircuit Modules (SJ20668)

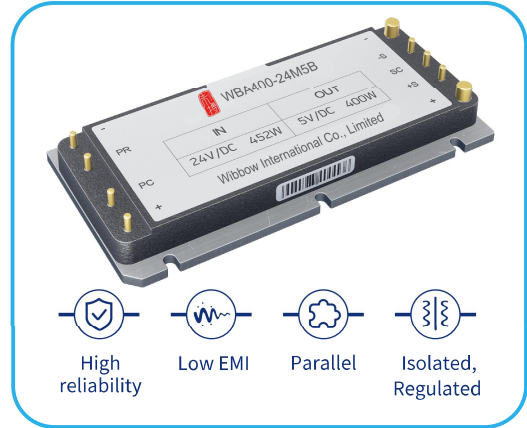

### Product specification

Product series	Input voltage range	Output voltage range	Adjustable range	Output current	Output power	Efficiency	Development progress
WBA300-24M3V3B	18~40V	3.3V	75%~110%	90.9A	300W	88.2%	In development
WBA400-24M5B	18~40V	5V	75%~110%	80A	400W	88.5%	In development
WBA300-24M8B	18~40V	8V	75%~110%	37.5A	300W	88.6%	In development
WBA400-24M12B	18~40V	12V	75%~110%	33.4A	400W	91.5%	In development
WBA400-24M15B	18~40V	15V	75%~110%	26.7A	400W	91.0%	In development
WBA500-24M24B	18~40V	24V	75%~110%	20.8A	500W	91.1%	In development
WBA500-24M28B	18~40V	28V	75%~110%	17.9A	500W	90.5%	In development
WBA500-24M36B	18~40V	36V	75%~110%	13.9A	500W	90.0%	In development
WBA500-24M48B	18~40V	48V	75%~110%	10.4A	500W	89.1%	In development

### Shape & Size

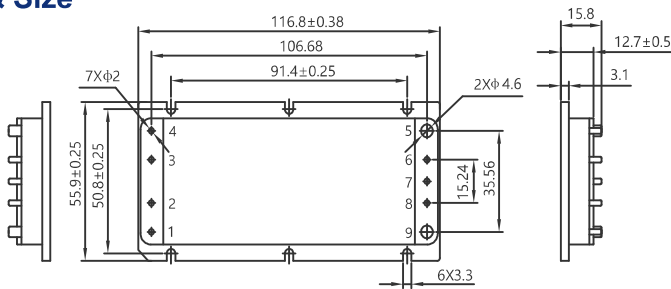

Pin No.	Label	Function
1	+IN	Positive input power terminal
2	PC	Primary side control
3	PR	Parallel terminal
4	-IN	Negative input power terminal
5	-OUT	Negative output power terminal
6	-S	Distal compensation negative terminal
7	SC	Secondary side control terminal
8	+S	Distal compensation positive terminal
9	+OUT	Positive output power terminal

### Part Numbering

WB	A	300	-	24	M	3V3	B
Brand Name	Package Type	Output power	-	Input voltage range	Temperature Grade	Output voltage range	Version
Wibbow	A: Full-brick B: 1/2 brick C: 1/4 brick	300: 300W 400: 400W 500: 500W		24: 18~40V	M: Tc: -55~100°C Ts: -65~100°C H: Tc: -40~100°C Ts: -55~100°C T: Tc: -40~100°C Ts: -40~100°C	3V3: 3.3V 5: 5V 8: 8V 12: 12V 15: 15V 24: 24V 28: 28V 36: 36V 48: 48V	B: Standard version



## WBC300 Series Quarter Brick power supply

### Features

- Isolated, Regulated
- Variable frequency control, mixed insertion with Vicor V300C series
- Input surge resistance: 400V/100ms
- Wide output adjustment range: 75%-110%
- About 5% higher efficiency than similar Vicor products
- Over-voltage, under-voltage, over-current, short-circuit and thermal protections
- Supports 8 parallel expansion (without ORING);
- 3000Vac isolation
- Operating temperature: -55°C~100°C (non-derating)
- Quarter brick standard package: 57.9 x 36.8 x 12.7 mm
- Comply with the General Specification for Microcircuit Modules (SJ20668)

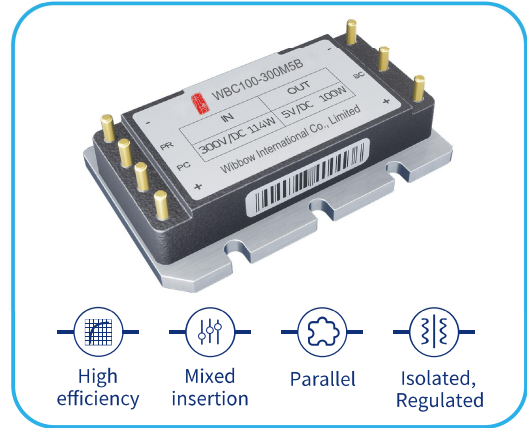

### Product specification

Product series	Input voltage range	Output voltage range	Adjustable range	Output current	Output power	Efficiency	Development progress
WBC75-300M3V3B	180~375V	3.3V	75%~110%	22.72A	75W	86%	Available
WBC100-300M5B	180~375V	5V	75%~110%	20A	100W	89%	Available
WBC100-300M8B	180~375V	8V	75%~110%	12.5A	100W	88.5%	Available
WBC150-300M12B	180~375V	12V	75%~110%	12.5A	150W	89.5%	Available
WBC150-300M15B	180~375V	15V	75%~110%	10A	150W	90.7%	Available
WBC150-300M24B	180~375V	24V	75%~110%	6.25A	150W	90.5%	Available
WBC150-300M28B	180~375V	28V	75%~110%	5.36A	150W	90.5%	Available
WBC150-300M36B	180~375V	36V	75%~110%	4.17A	150W	90.5%	Available
WBC150-300M48B	180~375V	48V	75%~110%	3.13A	150W	91%	Available

### Shape & Size

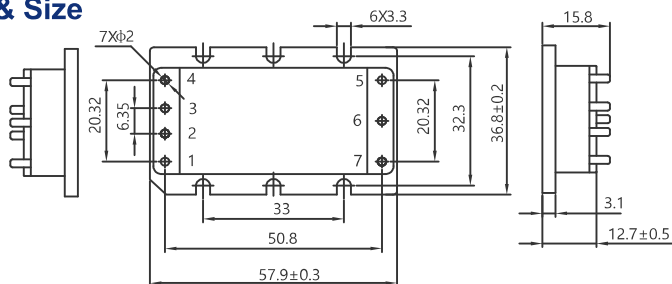

Pin No.	Label	Function
1	+IN	Positive input power terminal
2	PC	Primary side control
3	PR	Parallel terminal
4	-IN	Negative input power terminal
5	-OUT	Negative output power terminal
6	SC	Secondary side control terminal
7	+OUT	Positive output power terminal

### Part Numbering

WB	C	75	-	300	M	3V3	B
Brand Name	Package Type	Output power	-	Input voltage range	Temperature Grade	Output voltage range	Version
Wibbow	A: Full-brick B: 1/2 brick C: 1/4 brick	75: 75W 100: 100W 150: 150W		300: 180~375V	M : Tc: -55~100°C Ts: -65~100°C H : Tc: -40~100°C Ts: -55~100°C T : Tc: -40~100°C Ts: -40~100°C	3V3: 3.3V 5: 5V 8: 8V 12: 12V 15: 15V 24: 24V 28: 28V 36: 36V 48: 48V	B: Standard version



## WBB300 Series Half-brick DC-DC Converter

### Features

- Isolated, Regulated
- Variable frequency control, mixed insertion with Vicor V300B series
- Input surge resistance: 400V/100ms
- Wide output adjustment range: 75%~110%
- About 5% higher efficiency than similar Vicor products
- Over-voltage, under-voltage, over-current, short-circuit and thermal protections
- Supports 8 parallel expansion (ORING not required)
- 3000Vac isolation
- Operating temperature: -55°C~100°C (non-derating)
- Half-brick standard package: 57.9 × 55.9 × 12.7 mm
- Comply with the General Specification for Microcircuit Modules (SJ20668)

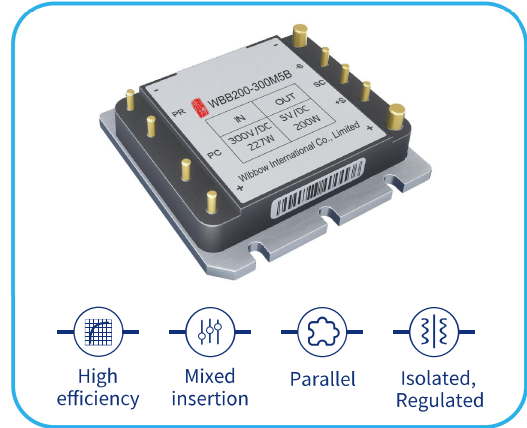

### Product specification

Product series	Input voltage range	Output voltage range	Adjustable range	Output current	Output power	Efficiency	Development progress
WBB150-300M3V3B	180~375V	3.3V	75%~110%	45.4A	150W	85%	Available
WBB200-300M5B	180~375V	5V	75%~110%	40A	200W	89%	Available
WBB200-300M8B	180~375V	8V	75%~110%	25A	200W	91%	Available
WBB250-300M12B	180~375V	12V	75%~110%	20.8A	250W	91%	Available
WBB250-300M15B	180~375V	15V	75%~110%	16.7A	250W	91.8%	Available
WBB250-300M24B	180~375V	24V	75%~110%	10.4A	250W	91.5%	Available
WBB250-300M28B	180~375V	28V	75%~110%	8.9A	250W	91.5%	Available
WBB250-300M36B	180~375V	36V	75%~110%	6.9A	250W	90.5%	Available
WBB250-300M48B	180~375V	48V	75%~110%	5.2A	250W	90.5%	Available

### Shape & Size

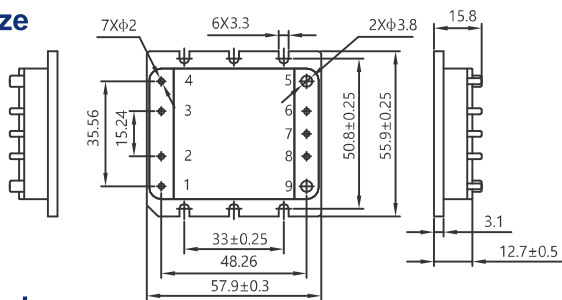

Pin No.	Label	Function
1	+IN	Positive input power terminal
2	PC	Primary side control
3	PR	Parallel terminal
4	-IN	Negative input power terminal
5	-OUT	Negative output power terminal
6	-S	Distal compensation negative terminal
7	SC	Secondary side control terminal
8	+S	Distal compensation positive terminal
9	+OUT	Positive output power terminal

### Part Numbering

WB	B	150	-	300	M	3V3	B
Brand Name	Package Type	Output power	-	Input voltage range	Temperature Grade	Output voltage range	Version
Wibbow	A: Full-brick B: 1/2 brick C: 1/4 brick	150: 150W 200: 200W 250: 250W		300: 180~375V	M : Tc: -55~100°C Ts: -65~100°C H : Tc: -40~100°C Ts: -55~100°C T : Tc: -40~100°C Ts: -40~100°C	3V3: 3.3V 5: 5V 8: 8V 12: 12V 15: 15V 24: 24V 28: 28V 36: 36V 48: 48V	B: Standard version



## WBA300 Series Full-brick DC-DC Converter

### Features

- Isolated, Regulated
- Variable frequency control, mixed insertion with Vicor V300A series
- Input surge resistance: 400V/100ms
- Wide output adjustment range: 75%~110%
- About 5% higher efficiency than similar Vicor products
- Over-voltage, under-voltage, over-current, short-circuit and thermal protections
- Supports 8 parallel expansion (ORING not required)
- 3000Vac isolation
- Operating temperature: -55°C~100°C (non-derating)
- Full-brick standard package: 116.8 × 55.9 × 12.7 mm
- Comply with the General Specification for Microcircuit Modules (SJ20668)

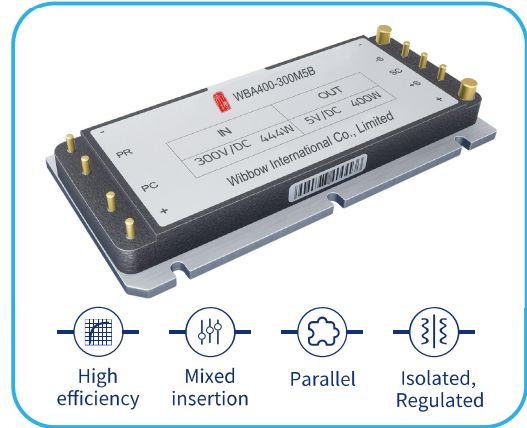

### Product specification

Product series	Input voltage range	Output voltage range	Adjustable range	Output current	Output power	Efficiency	Development progress
WBA264-300M3V3B	180~375V	3.3V	75%~110%	80A	264W	88%	Available
WBA400-300M5B	180~375V	5V	75%~110%	80A	400W	91%	Available
WBA400-300M8B	180~375V	8V	75%~110%	50A	400W	91.5%	Available
WBA600-300M12B	180~375V	12V	75%~110%	50A	600W	92.5%	Available
WBA600-300M15B	180~375V	15V	75%~110%	40A	600W	93%	Available
WBA600-300M24B	180~375V	24V	75%~110%	25A	600W	93%	Available
WBA600-300M28B	180~375V	28V	75%~110%	21.5A	600W	92.5%	Available
WBA600-300M36B	180~375V	36V	75%~110%	16.7A	600W	93%	Available
WBA600-300M48B	180~375V	48V	75%~110%	12.5A	600W	90.5%	Available

### Shape & Size

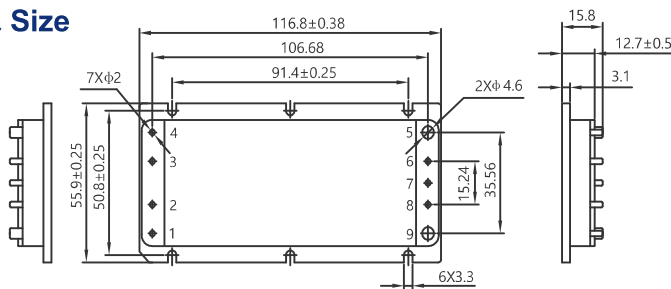

Pin No.	Label	Function
1	+IN	Positive input power terminal
2	PC	Primary side control
3	PR	Parallel terminal
4	-IN	Negative input power terminal
5	-OUT	Negative output power terminal
6	-S	Distal compensation negative terminal
7	SC	Secondary side control terminal
8	+S	Distal compensation positive terminal
9	+OUT	Positive output power terminal

### Part Numbering

WB	A	264	-	300	M	3V3	B
Brand Name	Package Type	Output power	-	Input voltage range	Temperature Grade	Output voltage range	Version
Wibbow	A: Full-brick B: 1/2 brick C: 1/4 brick	264: 264W 400: 400W 600: 600W		300: 180~375V	M: Tc: -55~100°C Ts: -65~100°C H: Tc: -40~100°C Ts: -55~100°C T: Tc: -40~100°C Ts: -40~100°C	3V3: 3.3V 5: 5V 8: 8V 12: 12V 15: 15V 24: 24V 28: 28V 36: 36V 48: 48V	B: Standard version





## WBC375 Series Quarter Brick DC-DC Converter

### Features

- Isolated, Regulated
- Variable frequency control, mixed insertion with Vicor V375C series
- Input surge resistance: 500V/100ms
- Wide-output voltage regulation range: 75% ~ 110%
- About 5% higher efficiency than similar Vicor products
- Over-voltage, under-voltage, over-current, short-circuit and thermal protections
- Supports 8 parallel expansion (ORING not required)
- 3000Vac isolation
- Operating temperature: -55°C~100°C (non-derating)
- Quarter brick standard package: 57.9 x36.8 x12.7 mm
- Comply with the General Specification for Microcircuit Modules (SJ20668)

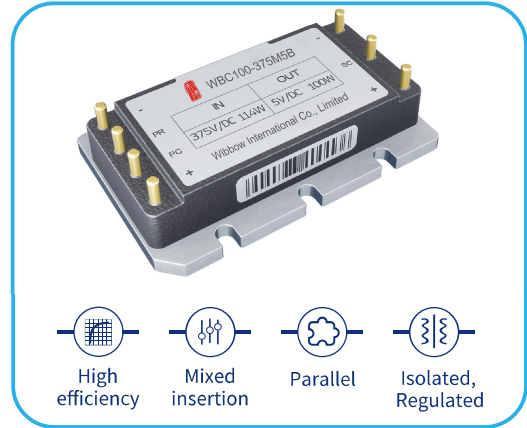

### Product specification

Product series	Input voltage range	Output voltage range	Adjustable range	Output current	Output power	Efficiency	Development progress
WBC75-375M3V3B	250~425V	3.3V	75%~110%	22.7A	75W	86.5%	Available
WBC100-375M5B	250~425V	5V	75%~110%	20A	100W	89%	Available
WBC100-375M8B	250~425V	8V	75%~110%	12.5A	100W	88.5%	Available
WBC150-375M12B	250~425V	12V	75%~110%	12.5A	150W	89.5%	Available
WBC150-375M15B	250~425V	15V	75%~110%	10A	150W	90.7%	Available
WBC150-375M24B	250~425V	24V	75%~110%	6.25A	150W	90.2%	Available
WBC150-375M28B	250~425V	28V	75%~110%	5.36A	150W	90.5%	Available
WBC150-375M36B	250~425V	36V	75%~110%	4.17A	150W	90.2%	Available
WBC150-375M48B	250~425V	48V	75%~110%	3.13A	150W	90.2%	Available

### Shape & Size

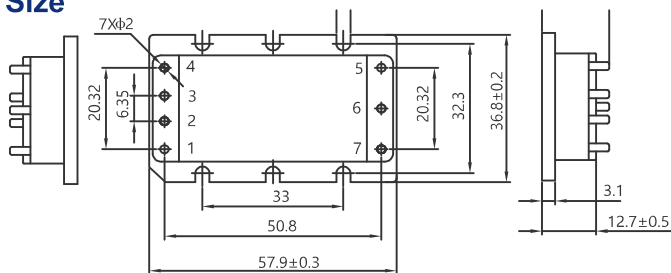

Pin No.	Label	Function
1	+IN	Positive input power terminal
2	PC	Primary side control
3	PR	Parallel terminal
4	-IN	Negative input power terminal
5	-OUT	Negative output power terminal
6	SC	Secondary side control terminal
7	+OUT	Positive output power terminal

### Part Numbering

WB	C	75	-	375	M	3V3	B
Brand Name	Package Type	Output power	-	Input voltage range	Temperature Grade	Output voltage range	Version
Wibbow	A: Full-brick B: 1/2 brick C: 1/4 brick	75: 75W 100: 100W 150: 150W		375: 250~425V	M : Tc: -55~100°C Ts: -65~100°C H: Tc: -40~100°C Ts: -55~100°C T : Tc: -40~100°C T : -40~100°C	3V3: 3.3V 5: 5V 8: 8V 12: 12V 15: 15V 24: 24V 28: 28V 36: 36V 48: 48V	B: Standard version



## WBB375 Series Half-brick module DC-DC Converter

### Features

- Isolated, Regulated
- Variable frequency control, mixed insertion with Vicor V375B series
- Input surge resistance: 500V/100ms
- Wide output adjustment range: 75%-110%
- About 5% higher efficiency than similar Vicor products
- Over-voltage, under-voltage, over-current, short-circuit and thermal protections
- Supports 8 parallel expansion (without ORING)
- 3000Vac isolation of primary and secondary sides
- Operating temperature: -55°C~100°C (non-derating)
- Half-brick standard package: 57.9 x 55.9 x 12.7 mm
- Comply with the General Specification for Microcircuit Modules (SJ20668)

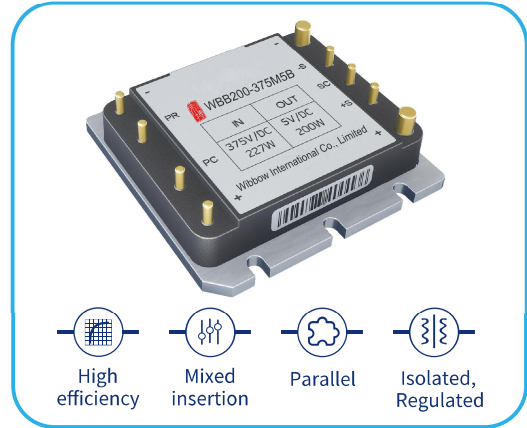

### Product specification

Product series	Input voltage range	Output voltage range	Adjustable range	Output current	Output power	Efficiency	Development progress
WBB150-375M3V3B	250~425V	3.3V	75%~110%	45.45A	150W	85%	Available
WBB200-375M5B	250~425V	5V	75%~110%	40A	200W	89%	Available
WBB200-375M8B	250~425V	8V	75%~110%	25A	200W	91%	Available
WBB300-375M12B	250~425V	12V	75%~110%	25A	300W	90.5%	Available
WBB300-375M15B	250~425V	15V	75%~110%	20A	300W	91.5%	Available
WBB300-375M24B	250~425V	24V	75%~110%	12.5A	300W	91.5%	Available
WBB300-375M28B	250~425V	28V	75%~110%	10.71A	300W	92%	Available
WBB300-375M36B	250~425V	36V	75%~110%	8.33A	300W	91.5%	Available
WBB300-375M48B	250~425V	48V	75%~110%	6.25A	300W	91.5%	Available

### Shape & Size

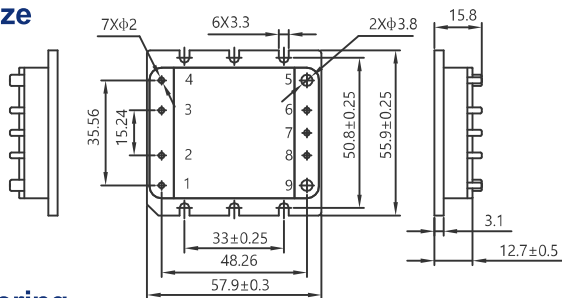

Pin No.	Label	Function
1	+IN	Positive input power terminal
2	PC	Primary side control
3	PR	Parallel terminal
4	-IN	Negative input power terminal
5	-OUT	Negative output power terminal
6	-S	Distal compensation negative terminal
7	SC	Secondary side control terminal
8	+S	Distal compensation positive terminal
9	+OUT	Positive output power terminal

### Part Numbering

WB	B	150	-	375	M	3V3	B
Brand Name	Package Type	Output power	-	Input voltage range	Temperature Grade	Output voltage range	Version
Wibbow	A: Full-brick B: 1/2 brick C: 1/4 brick	150: 150W 200: 200W 300: 300W		375: 250~425V	M : Tc: -55~100°C Ts: -65~100°C H : Tc: -40~100°C Ts: -55~100°C T : Tc: -40~100°C Ts: -40~100°C	3V3: 3.3V 5: 5V 8: 8V 12: 12V 15: 15V 24: 24V 28: 28V 36: 36V 48: 48V	B: Standard version



## WBA375 Series Full-brick module DC-DC Converter

### Features

- Isolated, Regulated
- Variable frequency control, mixed insertion with Vicor V375A series
- Input surge resistance: 500V/100ms
- Wide-output voltage regulation range: 75% ~ 110%
- About 5% higher efficiency than similar Vicor products
- Over-voltage, under-voltage, over-current, short-circuit and thermal protections
- Supports 8 parallel expansion (ORING not required)
- 3000Vac isolation
- Operating temperature: -55°C~100°C (non-derating)
- Full-brick standard package: 116.8 × 55.9 × 12.7 mm
- Comply with the General Specification for Microcircuit Modules (SJ20668)

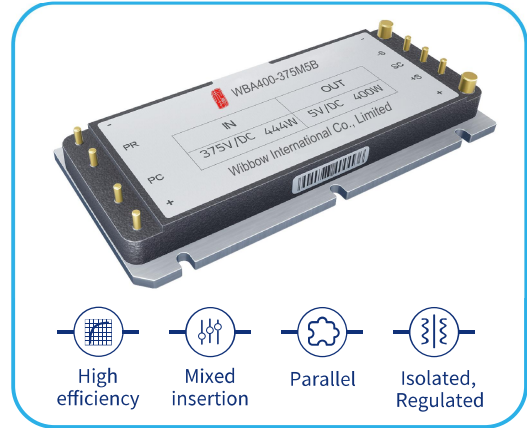

### Product specification

Product series	Input voltage range	Output voltage range	Adjustable range	Output current	Output power	Efficiency	Development progress
WBA264-375M3V3B	250~425V	3.3V	75%~110%	80A	264W	88%	Available
WBA400-375M5B	250~425V	5V	75%~110%	80A	400W	90%	Available
WBA400-375M8B	250~425V	8V	75%~110%	50A	400W	91.5%	Available
WBA600-375M12B	250~425V	12V	75%~110%	50A	600W	93%	Available
WBA600-375M15B	250~425V	15V	75%~110%	40A	600W	93%	Available
WBA600-375M24B	250~425V	24V	75%~110%	25A	600W	93%	Available
WBA600-375M28B	250~425V	28V	75%~110%	21.5A	600W	93%	Available
WBA600-375M36B	250~425V	36V	75%~110%	16.7A	600W	93.5%	Available
WBA600-375M48B	250~425V	48V	75%~110%	12.5A	600W	94%	Available

### Shape & Size

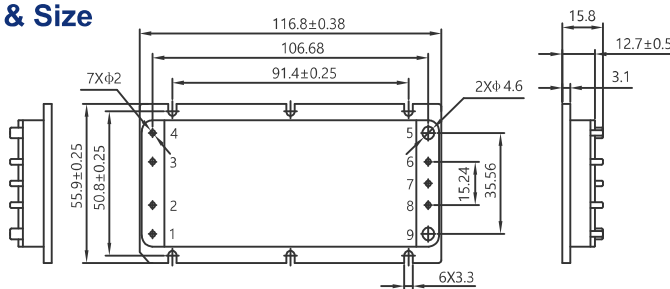

Pin No.	Label	Function
1	+IN	Positive input power terminal
2	PC	Primary side control
3	PR	Parallel terminal
4	-IN	Negative input power terminal
5	-OUT	Negative output power terminal
6	-S	Distal compensation negative terminal
7	SC	Secondary side control terminal
8	+S	Distal compensation positive terminal
9	+OUT	Positive output power terminal

### Part Numbering

WB	A	264	-	375	M	3V3	B
Brand Name	Package Type	Output power	-	Input voltage range	Temperature Grade	Output voltage range	Version
Wibbow	A: Full-brick B: 1/2 brick C: 1/4 brick	264: 264W 400: 400W 600: 600W		375: 250~425V	M : Tc: -55~100°C Ts: -65~100°C H : Tc: -40~100°C Ts: -55~100°C T : Tc: -40~100°C Ts: -40~100°C	3V3: 3.3V 5: 5V 8: 8V 12: 12V 15: 15V 24: 24V 28: 28V 36: 36V 48: 48V	B: Standard version



## WBM-FIAM Series EMI input filter attenuation module

### Features

- Wide input voltage range: 180 ~ 375V
- Pin-to-Pin compatible with Vicor M-FIAM series
- High input surge: 400V/100ms
- Comply with the EMC standards such as CE101 and CE102
- EM filter, transient protection, surge current suppression
- Suitable for V300 series DC/DC modules
- Operating temperature: -55°C~100°C (non-derating)
- Half-brick standard package: 57.9 x 55.9 x 12.7 mm
- Comply with the General Specification for Microcircuit Modules (SJ20668)

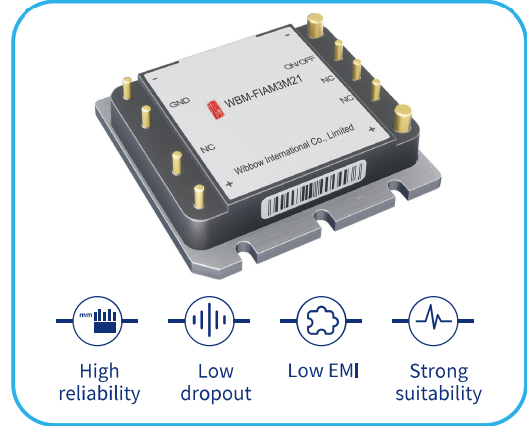

### Product specification

Product series	Input voltage range	Internal voltage drop	Output current	EMC	Efficiency	Development progress
WBM-FIAM3M21	180-375V	5V	3A	CE101/CE102	98%	Available

### Shape & Size

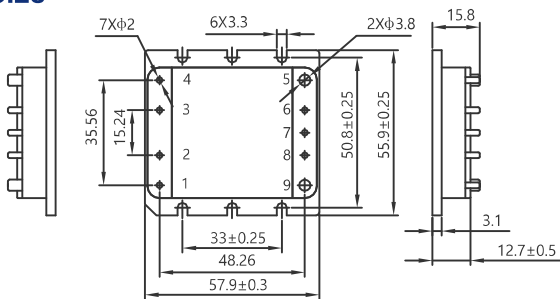

Pin No.	Label	Function
1	+IN	Positive input power terminal
2	NC	NULL
3	GND	EMI/GND
4	-IN	Negative input power terminal
5	-OUT	Negative output power terminal
6	ON/OFF	Control switch
7	NC	NULL
8	NC	NULL
9	+OUT	Positive output power terminal

### Part Numbering

WB	M-FIAM	3	M	2	1
Brand Name	Series name	Output Current	Temperature Grade	Pin form	Base plate
Wibbow	M-FIAM Brick DC-DC Converter	3: 3A	M : T <sub>c</sub> : -55~100°C T <sub>s</sub> : -65~100°C H : T <sub>c</sub> : -40~100°C T <sub>s</sub> : -55~100°C T : T <sub>c</sub> : -40~100°C T : -40~100°C	2: Long pin	1: Slotting



## WB $\mu$ RAM Series Ripple attenuation module

### Features

- Wide input voltage range: 3V ~ 30V
- High efficiency: 98%
- Output ripple:  $\leq 10\text{mV}$
- High-frequency ripple attenuation:  $> 40\text{dB}$  (1.1kHz-1MHz)
- Low-frequency ripple attenuation:  $> 40\text{dB}$  (100Hz-1.1kHz)
- Pin-to-Pin compatible with Vicor  $\mu$ RAM series
- Parallel expansion (reverse current protection)
- Match Vicor V300 and V375 series
- Operating temperature:  $-55^{\circ}\text{C}\sim 100^{\circ}\text{C}$  (non-derating)
- Quarter brick standard package:  $57.9 \times 36.8 \times 12.7\text{ mm}$
- Comply with the General Specification for Microcircuit Modules (SJ20668)

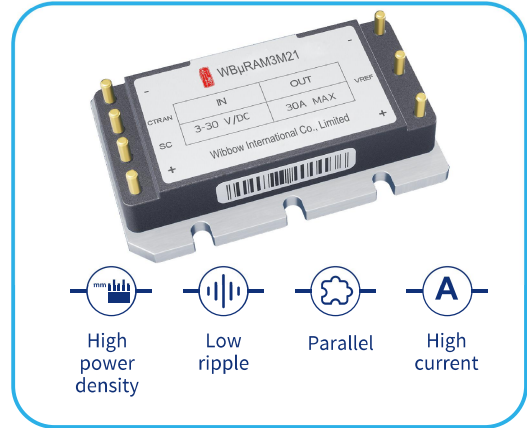

### Product specification

Product series	Input voltage range	Output ripple	differential pressure	Output current	Dynam response	Efficiency	progress
WB $\mu$ RAM2M21	3~30V	10mV	425mV	20A	50mV <sub>p-p</sub>	98%	Available
WB $\mu$ RAM3M21	3~30V	10mV	425mV	30A	50mV <sub>p-p</sub>	98%	Available
WB $\mu$ RAM4M21	3~30V	10mV	425mV	40A	50mV <sub>p-p</sub>	98%	Available

### Shape & Size

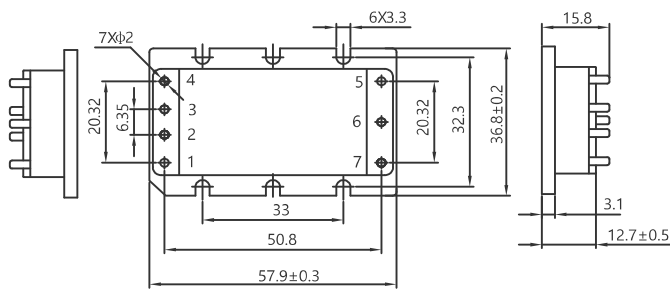

Pin No.	Label	Function
1	+IN	Positive input power terminal
2	SC	Control terminal
3	CTAN	External capacitor terminal
4	-IN	Negative input power terminal
5	-OUT	Negative output power terminal
6	VREF	Secondary side control
7	+OUT	Positive output power terminal

### Part Numbering

WB	$\mu$ RAM	2	M	2	1
Brand Name	Series name	Output Current	Temperature Grade	Pin form	Base plate
Wibbow	$\mu$ RAM Brick DC-DC Converter	2: 20A 3: 30A 4: 40A	M: $T_c: -55\sim 100^{\circ}\text{C}$ $T_s: -65\sim 100^{\circ}\text{C}$ H: $T_c: -40\sim 100^{\circ}\text{C}$ $T_s: -55\sim 100^{\circ}\text{C}$ T: $T_c: -40\sim 100^{\circ}\text{C}$ $T_s: -40\sim 100^{\circ}\text{C}$	2: Long pin	1: Slotting



## WBVI-ARM Series Ripple attenuation module

### Features

- Wide AC input range: 180Vac ~ 264Vac
- High input surge voltage: 280Vac/100ms
- Input surge current  $\leq 30A$
- Pin-to-Pin compatible with Vicor VI-ARM series
- Normal DC output indication function
- Match Vicor V300 series
- Isolation: input/output to substrate  $\geq 1500 VRMS$
- Operating temperature:  $-55^{\circ}C \sim 100^{\circ}C$  (non-derating)
- Quarter brick standard package: 57.9 x 36.8 x 12.7 mm
- Comply with the General Specification for Microcircuit Modules (SJ20668)

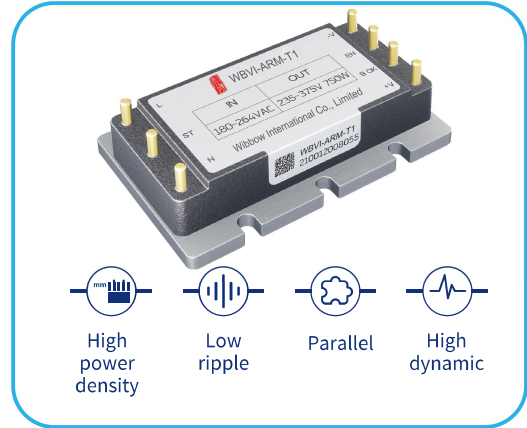

### Product specification

Product series	Input voltage range	Output voltage	Input frequency	Typical value of input voltage	Power	Efficiency	Development progress
WBVI-ARM-M12	180~264Vac	200-375V	47-63Hz	220Vac	750W	96%	Available

### Shape & Size

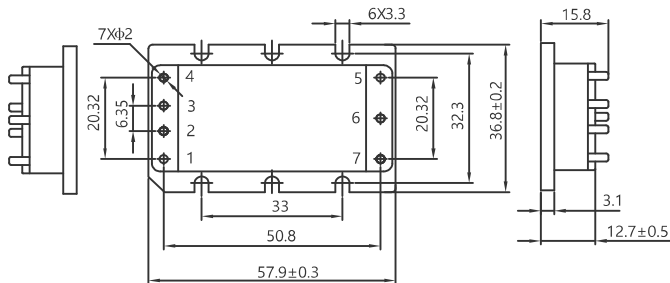

Pin No.	Label	Function
1	-V	-OUT
2	EN	Enables and disables power supply
3	B OK	Normal bus voltage indication
4	+V	+OUT
5	N	N-phase
6	ST	NULL
7	L	L-phase

### Part Numbering

WB	VI	-	ARM	-	M	1	2
Brand Name	Series name	-	Rectifier regulation	-	Temperature Grade	Power class	Pin length
Wibbow	VI-ARM Brick DC-DC Converter				M : Tc: -55~100°C Ts: -65~100°C H : Tc: -40~100°C Ts: -55~100°C T : Tc: -40~100°C T : -40~100°C		